

Technical Information



Design

BSEN40, PD6547: 2004+A1: 2009 (No sign)

Load class B

Deflection class 3

Head load- See Table

Finish

Galvanised to BSEN 1461:2009

Welding

In accordance with BSEN1011

Procedures to BSEN ISO 15614-1:2004

Welders qualified to BSEN 287-1:2004

* Maximum design head load based on wind loading region with orientation of bracket/ luminaire(s) being on same plane as door

Maximum Loading including Bracket		
Wind Loading Region	Terrain Category	Weight/Area
Extra Light	II	55kg/0.48m ²
	III	60kg/0.63m ²
Light	II	40kg/0.42m ²
	III	60kg/0.53m ²
Medium	II	38kg/0.38m ²
	III	50kg/0.49m ²
Heavy	II	35kg/0.34m ²
	III	45kg/0.44m ²
Extra Heavy	II	30kg/0.25m ²
	III	34kg/0.33m ²

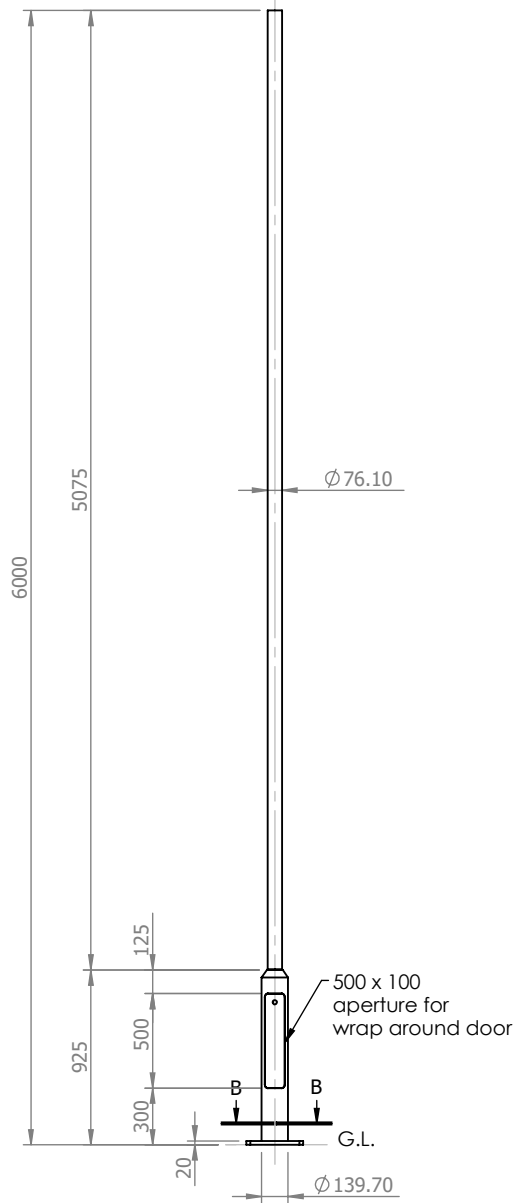
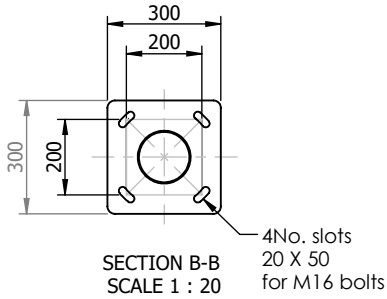

2012 © Copyright



Nottingham Limited, Hamilton Road,
Sutton in Ashfield Notts. NG17 5LN

www.fabrikat.co.uk

Tel.01623 442200

technical@fabrikat.co.uk

Fax.01623 442233

Notes

All dimensions in millimetres unless stated otherwise.

When Multiple views are shown 3rd Angle Projection is assumed.

Revisions		
Rev.	Description	Date
1	Loading Table Added	21/11/2013

Title

6 Metre Tubular Post Top Column

Drg No. 28779-1

Scale:1:40

Sheet 1

Drawn By: MJB

Chk'd: MB

Ref. 6M01A FP

Contract:

Customer:

Date: 07/11/12